

CONSUMER INSTALLATION GUIDE

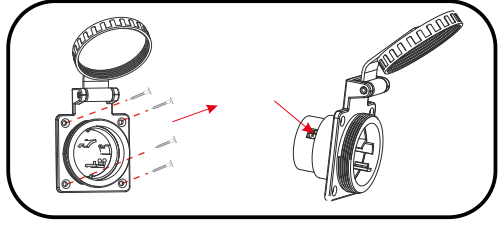

Turn off Rv's main breaker. Use a screwdriver to loosen and remove the four screws and pull out the old inlet out of the RV. Loosen screws and disconnect the old inlet to any wires.

*TOOLS:

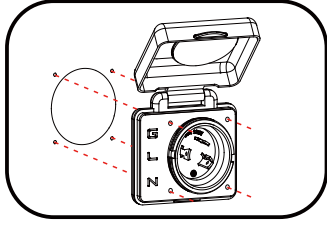

Test your new inlet for proper fit and hole alignment. Mark and drill new holes if needed.

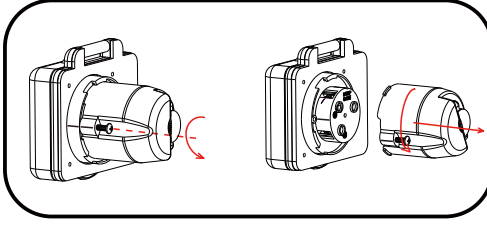

On the SafeView Power Inlet, loosen the screw on the rear housing. Rotate the rear housing counter clockwise and remove it.

*TOOLS:

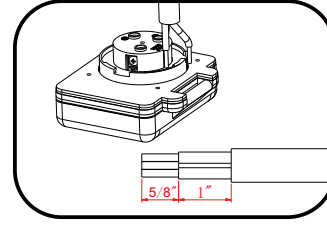

Please strip the wires as shown; strip off 1 5/8" of the outer insulation layer of the cable, and only 5/8" of the colored insulation of the conductor cables. Make sure the wire condition is good, full strands and shiny copper.

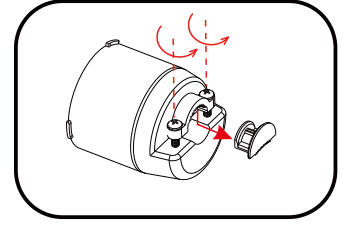

Loosen the screws and remove the cable bushing, this may be needed later.

*TOOLS:

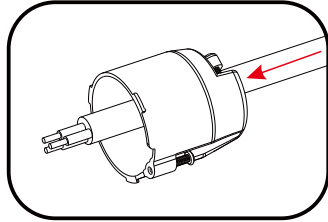

Insert the cable through the back of the rear housing

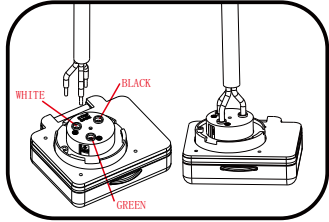

Connect the wires according to the matching color. W/white = neutral, G/green = ground, Y/Red = line. **Tighten the screws to 30-35 In/Lb.** Do not over tighten.

*TOOLS:

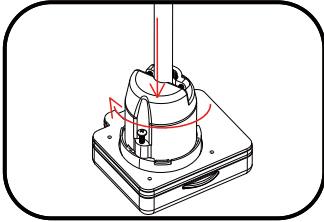

Install the rear housing and tighten the screw. **(3.0-3.9 In/Lb).**

*TOOLS:

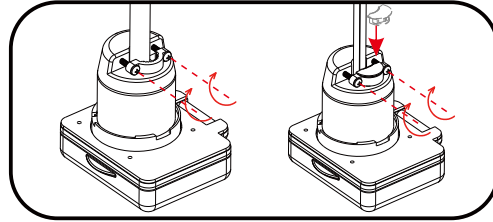

Tighten the screws on the strain relief clamp until they are snug around the cable. You may need to use the optional bushing to have a proper snug fit. **(4.5-5.5 In/Lb).**

*TOOLS:

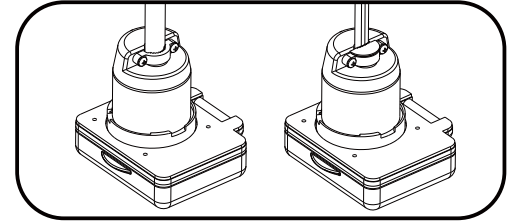

Make sure the wiring is tight and secured.

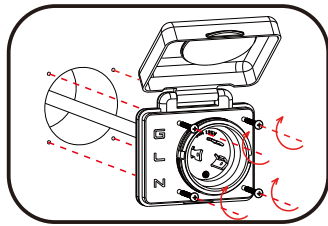

Reposition your new SafeView Power Inlet over the hole and align the screw holes. Secure the power inlet to the RV with the four screws. **(4.5-5.5 In/Lb).**

*TOOLS:

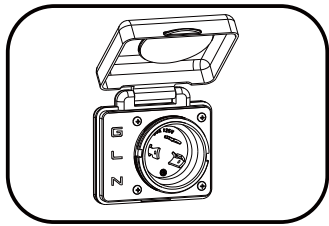

Verify proper installation. Make sure it is tight and secure.

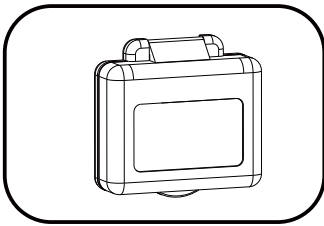

Press down the cover

RV MANUFACTURER INSTALLATION GUIDE

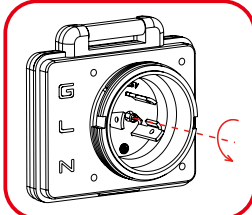

For Hipot Test-Make sure the screw is loose.

*TOOLS:

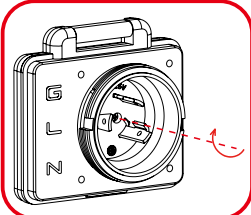

After Hipot Test-Make sure the screw is tightened down.

(FOR HIPOT TEST ONLY!!!)

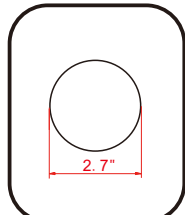

Make a hole of 2.7" diameter in the place where the INLET is to be installed

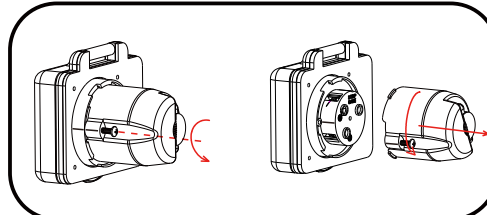

On the SafeView Power Inlet, loosen the screw on the rear housing. Rotate the rear housing counter clockwise and remove it.

*TOOLS:

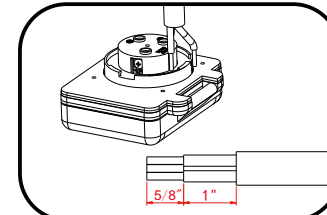

Please strip the wires as shown; strip off 1 5/8" of the outer insulation layer of the cable, and only 5/8" of the colored insulation of the conductor cables. Make sure the wire condition is good, full strands and shiny copper.

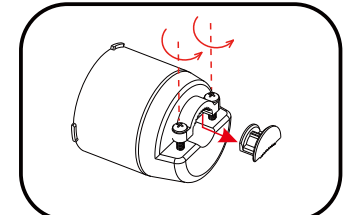

Loosen the screws and remove the cable bushing, this may be needed later.

*TOOLS:

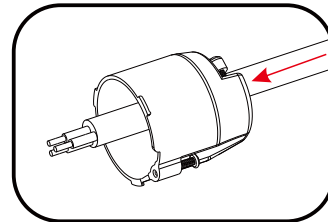

Insert the cable through the back of the rear housing

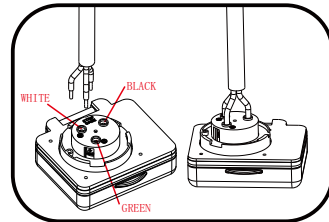

Connect the wires according to the matching color. W/white = neutral, G/green = ground, Y/Red = line. **Tighten the screws to 30-35 In/Lb.** Do not over tighten.

*TOOLS:

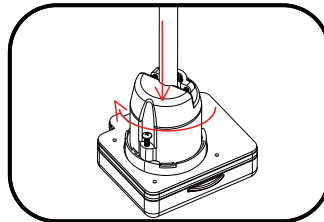

Install the rear housing and tighten the screw. **(3.0-3.9 In/Lb).**

*TOOLS:

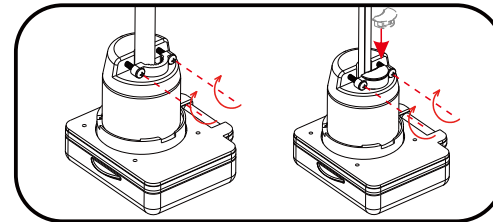

Tighten the screws on the strain relief clamp until they are snug around the cable. You may need to use the optional bushing to have a proper snug fit. **(4.5-5.5 In/Lb).**

*TOOLS:

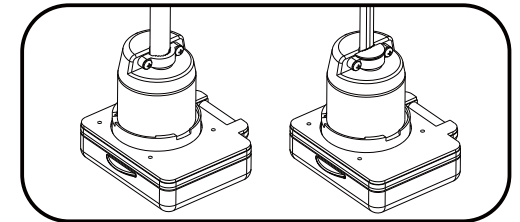

Make sure the wiring is tight and secured.

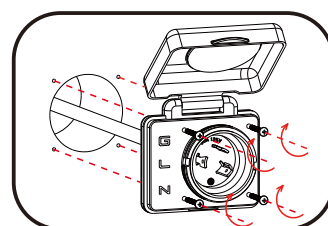

Reposition your new SafeView Power Inlet over the hole and align the screw holes. Secure the power inlet to the RV with the four screws. **(4.5-5.5 In/Lb).**

*TOOLS:

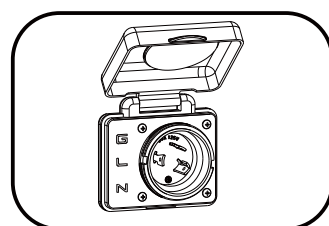

Verify proper installation. Make sure it is tight and secure.

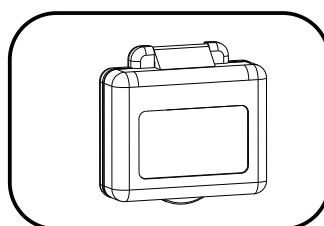

Press down the cover

Tools Needed

- Phillips Screwdriver
- Ruler/Measuring Tape
- Utility Knife
- Wire Cutters

